

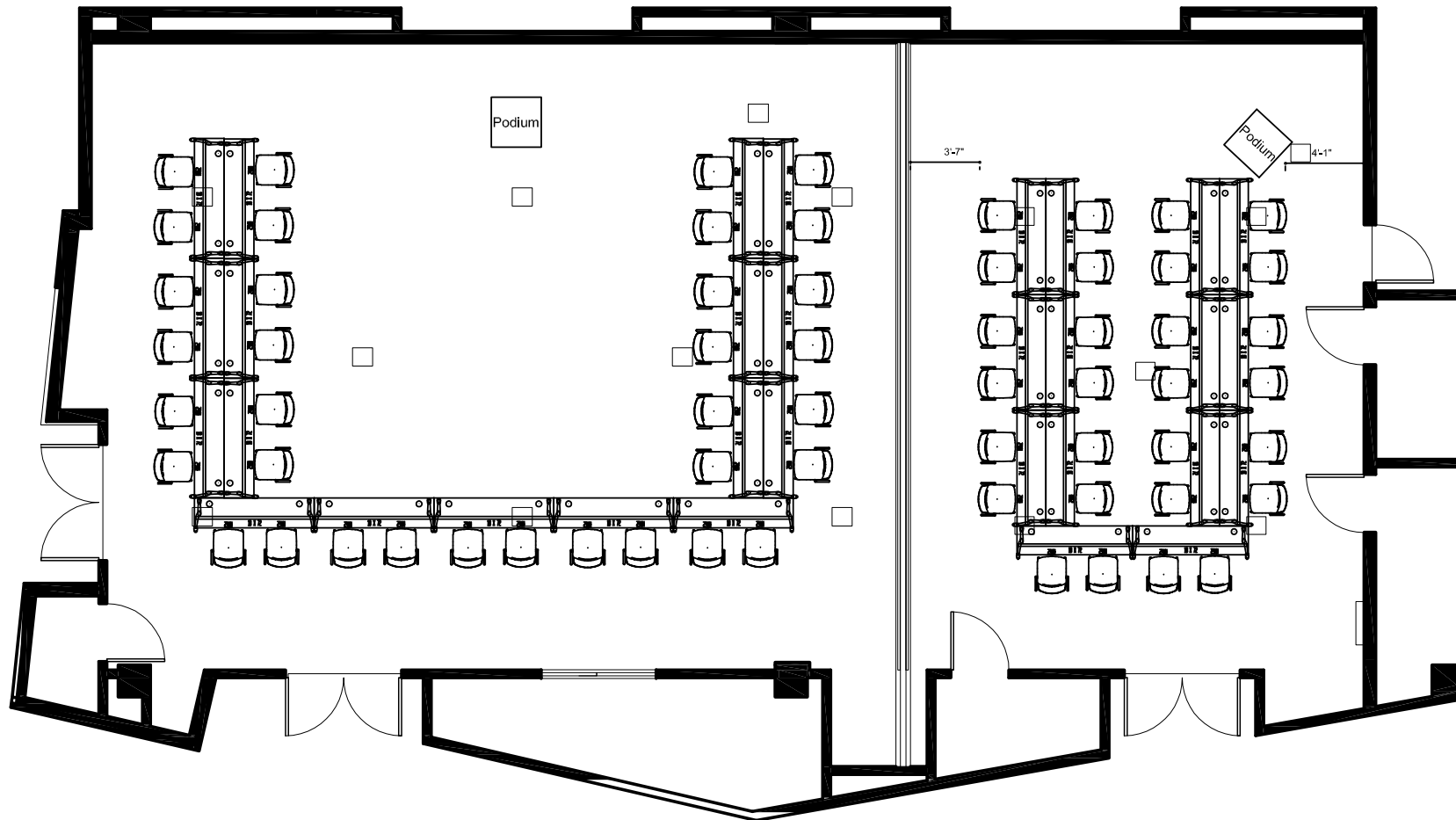

THE COLLIDER  
Climate Science • Ideas to Solutions  
thecollider.org

## Option 4: U-Shaped Capacity: Up to 51\*



\*Capacity increases with 3 to a table.

Effective June 11, 2016. Subject to change without notice.

### Theater A: 22 - 51\* Seats

With single or double (back-to-back) tables on sides: 34 - 51\*

With seats on the outside only: 22 - 33\*

### Theater B: 28 Seats

With single or double (back-to-back) tables on sides